



Pentair
Water

TEL: + 32 14 25 99 11
FAX: + 32 14 25 99 75

COMPOSITE INDUSTRIAL FLANGED VESSELS

6" TOP ONLY

DETAIL 6" FLANGE

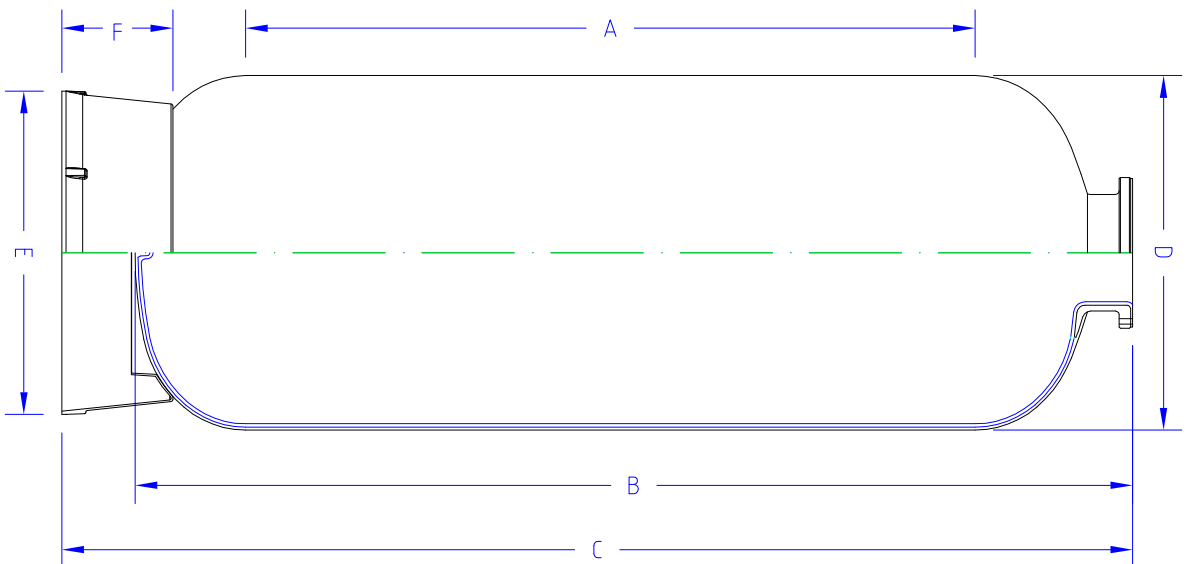
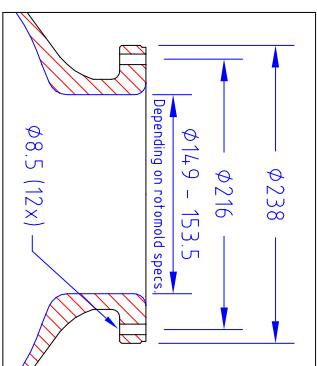

Operating pressure
Operating temperature

: min 0 bar – max 10 bar
: min 1°C – max 65°C

A	B	C	D	E	F						BASE	TYPE
838	1143	1187 ± 10	φ369	φ330	80	98	7.3	16	4.10	0	B-SMC-S16	C-1445-A3
1356	1661	1705 ± 10	φ369	φ330	80	138	7.3	22	4.10	0	B-SMC-S16	C-1468-A3
1338	1676	1717 ± 10	φ406	φ330	80	170	10.1	24.6	4.10	0	B-SMC-S16	C-1668-A3
1360	1719	1820 ± 15	φ469	φ516	174	248	14.6	34	690	0	B-SMC-S21	C-1868-A3
1150	1566	1679 ± 10	φ552	φ510	170	308	24	34.6	690	0	B-SMC-L21	C-2166-A3
1323	1797	1915 ± 10	φ610	φ516	174	450	35	42	990	0	B-SMC-L24	C-2475-A3
1305	1869	2085 ± 15	φ770	φ768	334	712	67	81.2	1590	0	B-SMC-X30	C-3078-A3
1242	1892	2151 ± 15	φ927	φ768	334	1020	116	104	2240	0	B-SMC-X36	C-3678-A3
1141	1918	2047 ± 20	φ1074	φ890	206	1345	176	168.5	2990	0	B-SMC-L42	C-4278-A3
1138	1972	2127 ± 15	φ1226	φ1095	276	1830	273	194	4040	0	B-SMC-L48	C-4882-A3

Revision	Revision description	Drawn	Date
e	Adjust dims. A,C + added base & lifting lugs (ECN160003)	BV	16/02/2016
d	Adjust dims. B and C and volume according to ECN05083,068,085,086,087	LVDS	09/01/2006
c	Adjust dims. 1200 into 1162, 1878 into 1930 and 1998-2038 into 2050-2090	LVDS	14/03/02

Article :
Cad filename : CD-TP-I-220
Date : 2 April 1997
Model filename :
Drawn : Ludo Van den Schoor
Remarks : Boxed dims. are critical for Q.A.
Approved : P.K.
Material :
Projection :

Description :
INDUSTRIAL TOP FL. COMPOSITE VESSEL
Drawing number :
CD-TP-I-220e