



Pentair  
Water  
TEL: + 32 14 25 99 11  
FAX: + 32 14 25 99 75

# COMPOSITE INDUSTRIAL FLANGED VESSELS

6" TOP - 6" BOTTOM

DETAIL 6" FLANGE

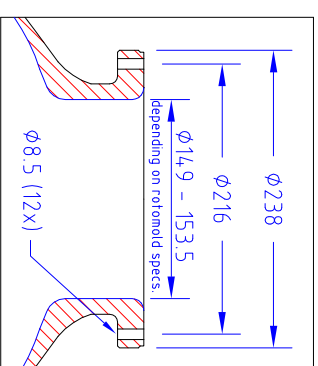

DETAIL BASE

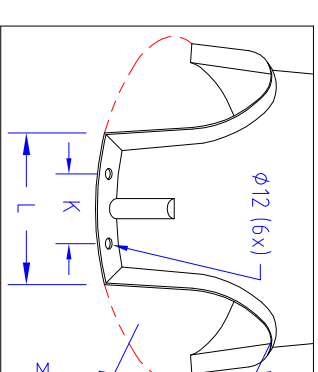

Operating pressure : min 0 bar - max 10 bar  
Operating temperature : min 1°C - max 80°C

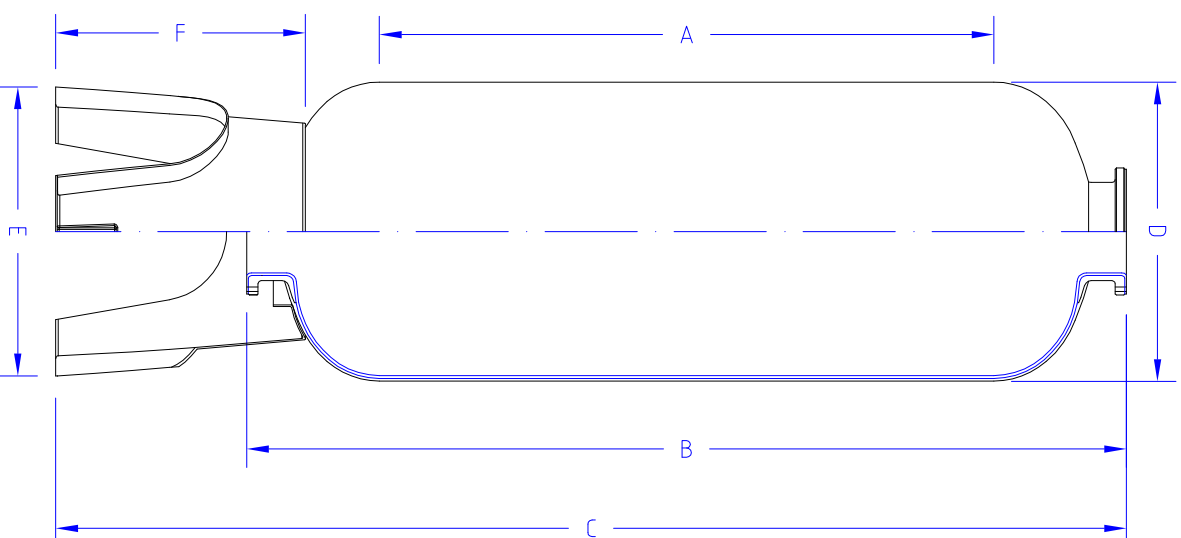

A	B	C	D	E	F	/	/	/	/	/	K	L	M	/	BASE	TYPE
1369	1736	2072 ± 10	Ø369	Ø497	469	140	7.3	33	405	110	184	292	0	B-SMC-F16	C-1468-F7HW	
1356	1748	2085 ± 10	Ø406	Ø497	469	172	10.1	42	405	110	184	292	0	B-SMC-F16	C-1668-F7HW	
1345	1780	2129 ± 15	Ø469	Ø545	465	250	14.6	45	710	110	245	292	0	B-SMC-F21	C-1868-F7HW	
1158	1642	1995 ± 10	Ø552	Ø545	465	310	24	48	710	110	245	292	0	B-SMC-F21	C-2166-F7HW	
1320	1866	2224 ± 10	Ø610	Ø698	476	450	35	58	995	110	223	297	0	B-SMC-F24	C-2475-F7HW	
1284	1924	2284 ± 15	Ø770	Ø877	517	712	67	112	1590	110	240	318	0	B-SMC-F30	C-3078-F7HW	
1250	1975	2345 ± 20	Ø927	Ø952	553	1020	116	143	2245	110	265	368	0	B-SMC-F36	C-3678-F7HW	
1162	1980	2419 ± 20	Ø1074	Ø1092	589	1345	176	176	2990	110	278	387	0	B-SMC-F42	C-4278-F7HW	
1056	2033	2441 ± 15	Ø1226	Ø1270	598	1830	273	250	4040	110	316	387	0	B-SMC-F48	C-4882-F7HW	

g	Updated dim. A,C + add lifting lugs & base ECN160003	BV	08/02/2016
f	Modify base dimensions according to ECN06041	LVDS	08/09/2006
e	Adjust B, C dims and volume according to ECN05068,081,082,083,084,085,086,087)	LVDS	09/01/2006
Revision	Revision description	Drawn	Date

Article :  
 Cad filename : DG970024  
 Date : 2 April 1997  
 Model filename :  
 Drawn : Ludo Van den Schoor  
 Remarks : Boxed dims. are critical for Q.A.  
 Approved :  
 Material :  
 Projection :  
 Drawing number :

FLANGED HOT WATER COMPOSITE VESSEL  
 CD-TP-1-218g